



New

**Caratteristiche:**

Diffusori a schermo piano con flusso radiale a soffitto.

**Costruzione:**

Acciaio verniciato bianco RAL 9010.

**Impiego:**

A soffitto per immissione aria .  
Altezza di installazione: 2,8 - 3 m

**Fissaggio:**

Fissaggio con pannello su controsoffitto modulare.

**Accessori:**

- Plenum di raccordo in acciaio zincato.

**Characteristics:**

Flat screen diffuser with ceiling radial flow.

**Construction:**

RAL 9010 white painted steel.

**Utilization:**

Ceiling installation for air supply  
Installation height: 2,8 - 3 m.

**Fixing:**

Mounting with panel of modular ceiling.

**Accessories:**

- Galvanized steel connecting plenum.

**PREZZI / PRICES**

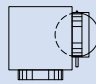
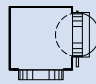
					Serranda per Plenum Damper for Plenum	Equalizzatore per Plenum Equalizer for Plenum
	DP	D1	PDC	PDCI		
Ø (mm)	€	Ø (mm)	€	€	€	€
160	-	159	-	-	-	-
200	-	199	-	-	-	-
250	-	249	-	-	-	-
315	-	314	-	-	-	-

**MISURE / MEASURES PLENUM PDC**

PLENUM	AxA	ØD	ØE
PDC 160	250x250	156	162
PDC 200	300x300	156	202
PDC 250	350x350	196	252
PDC 315	400x400	246	317

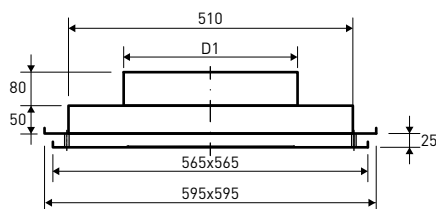
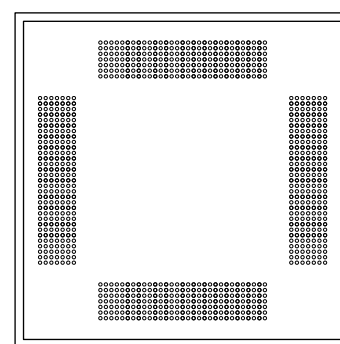
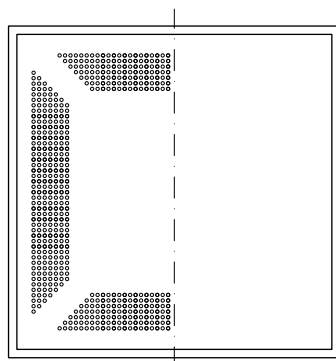
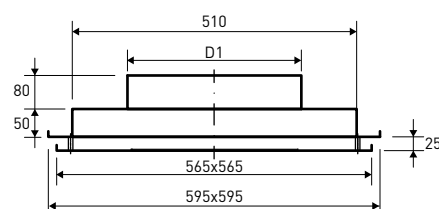
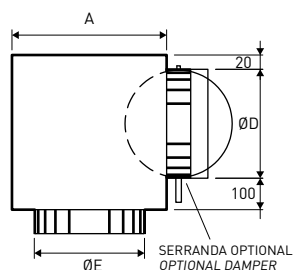
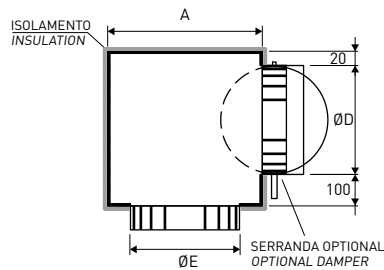
**DISEGNI / DRAWINGS****TIPO / TYPE A****TIPO / TYPE B****PDC****PDCI**

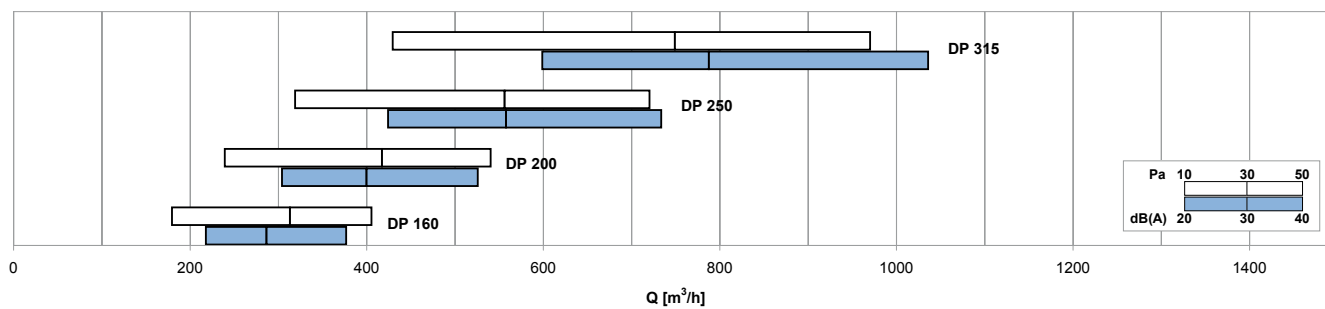
**DIAGRAMMA SCELTA RAPIDA / QUICK SELECTION DIAGRAM**

**TABELLA DI SELEZIONE / SELECTION TABLE**

Modello Model	Q [m³/h]		L <sub>WA</sub> [dB(A)]		X <sub>10,20</sub> [m]		Dp <sub>t</sub> [Pa]	
	min	max	min	max	min	max	min	max
<b>DP 160</b>	180	410	-	43	1,1	3,4	10	50
<b>DP 200</b>	240	540	-	41	1,6	5,1	10	50
<b>DP 250</b>	320	720	-	39	2,4	7,7	10	50
<b>DP 315</b>	430	970	-	38	3,7	11,8	10	50